

Taper-Lock[®] Adaptors

Adaptors for Fenner Taper-Lock[®] Bushes are available for use in parallel bored components, thereby eliminating the need to drill, tap and taper-bore.

Tightening of the Taper-Lock[®] Bush screws simultaneously contracts the bore of the bush and expands the adaptor in the bore of the hub resulting in the firmness of a press fit on all surfaces.

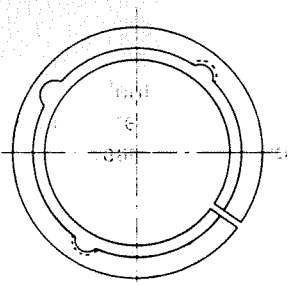

PLAIN TYPE PM

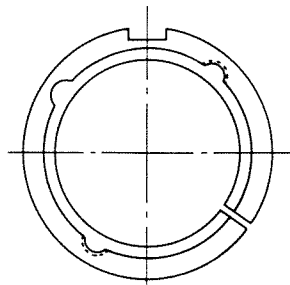

KEYWAYED TYPE KM

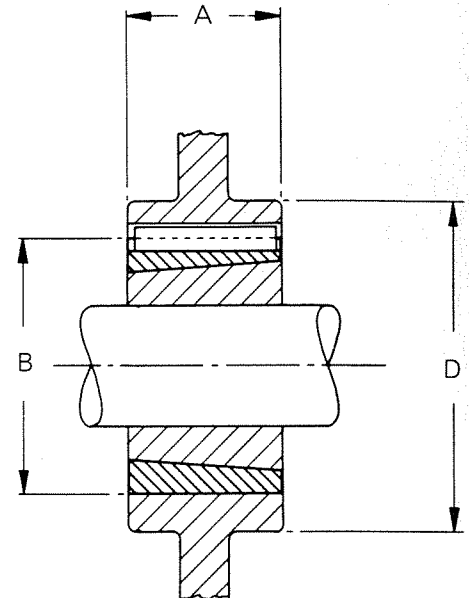

METRIC ADAPTORS

Catalogue Code	Adaptor Ref.	Use Bush Size	A	B*	D Hub dia. ‡			Key Section§
					Cast Iron B.S. 1452		Steel B.S.970Pt1 Grade 070M20	
					Grade 150	Grade 220		
030A0200 030A0210	1008PM 1008KM	1008	22	45	71 75	62 67	56 60	— 5 × 5
030C0200 030C0210	1210PM 1210KM	1210	25	60	97 103	85 93	76 85	— 6 × 6
030G0200 030G0210	1610PM 1610KM	1610	25	70	106 113	95 102	86 92	— 10 × 8
030H0200 030H0210	1615PM 1615KM	1615	38	70	97 104	89 95	83 89	— 10 × 8
030M0200 030M0210	2517PM 2517KM	2517	45	105	145 151	133 140	121 127	— 16 × 10
030Q0200 030Q0210	3030PM 3030KM	3030	76	130	181 191	165 175	156 159	— 20 × 12
030R0200 030R0210	3535PM 3535KM	3535	90	160	225 235	203 213	191 200	— 22 × 12
030S0200 030S0210	4040PM 4040KM	4040	102	185	275 285	248 257	229 238	— 24 × 12

® Registered Trade Mark

Dimensions in millimetres

*Bore tolerance of B +0.025 is recommended
+0.075

‡Figures in the D Hub dia columns are equally suitable for cast iron to 150R185 Grades 15 and 22 respectively.

For General Reference. Severe conditions may require larger hub. Required hub diameter depends on design and application. Heavy section web suitably located may permit use of smaller hub diameter—for guidance, send details of proposed design to Fenner.

§Specify Adaptor Ref. when ordering. Plain type (P) will be supplied unless Keywayed type (K) is indicated. For Keywayed type use appropriate keyway in hub. Key is not supplied. Use of a set screw in hub is not recommended.